

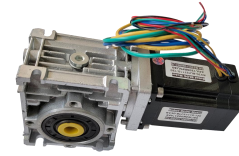

BLF5782-RV30

直流无刷减速电机

Worm gear brushless dc motor



特点Features:

*无刷结构, 无摩擦, 低噪声, 寿命更长brushless structure,no contact, no friction ,lower noise,longer life time than brushed.
*无刷,无接触电阻,效率更高brushless,no contact resistance,no voltage loss, has higher efficiency
*无积碳, 更可靠brushless,no carbon deposit,more reliable

应用Application:

搬运车, 轨道交通, 机器人, 数控设备, 农业, 办公设备, 工业设备, 军用设备
AGV,Rail Transport,Robot,Agricultural machine, CNC,Industrial machinery,military machinery

电机型号 Model of electric motor	BLF5782												
电机类型 Motor structure	Brushless PM												
额定电压(V) Rated voltage	12						24						
空载电流(A) No load current	0.4						0.2						
空载转速(RPM) No load speed	2000						2000						
额定电流(A) Rated current	1.4						1.4						
额定转速(RPM) Rated speed	1200						1200						
额定扭力(Kg.cm) Rated torque	1.75						1.75						
额定功率(W) Rated power	22						22						
堵转电流(A) Stall current	/						/						
堵转扭力(Kg.cm) Stall torque	/						/						
减速电机性能 Gear motor performance	BLF5782-RV30												
减速箱结构 Gear type	worm												
减速比(i) Ratio	5	7.5	10	15	20	25	30	40	50	60	80	100	
空载转速(RPM) No load speed	400	267	200	133	100	80	67	50	40	33	25	20	
输出扭矩(N.m) Output torque	0.7	1.05	1.4	2.1	2.8	3.5	4.2	5.6	7	8.4	11.2	14	
最大瞬时扭矩(N.m) Max. torque	14												
重量(Kg) Weight	2.5												

备注 note:

- 1.减速电机电压, 转速, 扭矩可在一定范围内定制; Voltage,speed and torque of gear motors can be customized within a certain range.
- 2.部分减速电机可以加装编码器或刹车制动器; Encoder and brake are optional for some gear motors.
- 3.减速电机可以正反转, 调速; Gear motors can rotate CW or CCW,and speed adjustable.
- 4.扭矩 (扭力) 单位换算: 1N.m=10.2kg.cm=8.85lb.Inch=142.86oz.Inch.

接线示意图

Wiring diagram

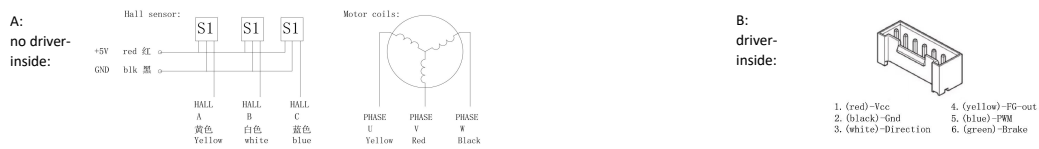

电机外形尺寸 (Unit: mm)

Outline & Dimension

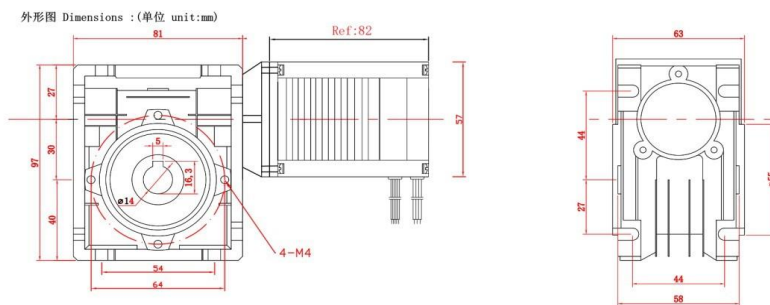

*尺寸图仅供参考, 减速箱的输出轴长, 轴径, 形状可以在一定范围内定制;

The drawing is for reference only,the shaft of gearbox can be customized within a certain range, such as the length,diameter and special shape.



BGM28D385

直流有刷减速电机 Spur gear brushed dc motor



特点Features:

- *有刷电机, 使用简单brush motor ,easy use.
- *正反转及调速方便Easy direction and speed control
- *可靠Reliable

应用Application:

搬运车, 轨道交通, 机器人, 农业机械, 太阳能设备, 道闸系统
AGV,Rail Transport,Robot,Agricultural machine,Solar machine, barrier gate system

电机型号 Model of electric motor	D385		
电机类型 Motor structure	Brushed PM		
额定电压(V) Rated voltage	6	12	24
空载电流(mA) No load current	200	240	120
空载转速(RPM) No load speed	7600	11000	11000
额定电流(mA) Rated current	1500	590	590
额定转速(RPM) Rated speed	5600	9100	9100
额定扭力(gf.cm) Rated torque	90	90	90
额定功率(W) Rated power	7.4	16.4	16.4
堵转电流(A) Stall current	5.1	5.8	2.9
堵转扭力(gf.cm) Stall torque	380	580	580

减速电机性能 Gear motor performance	BGM28D385 DC6V								
减速箱结构 Gear type	Spur								
减速比(i) Ratio	5.7	13	29	67	152	345	792	2139	
空载转速(RPM) No load speed	1330	580	260	110	49	22	10	4	
输出扭矩(kg.cm) Output torque	0.4	0.7	1.4	2.5	5	6	6	6	
堵转扭矩(kg.cm) Stall torque	1.5	2.5	6	10	25	40	50	80	

减速电机性能 Gear motor performance	BGM28D385 DC24V								
减速箱结构 Gear type	Spur								
减速比(i) Ratio	5.7	13	29	67	152	345	792	2139	
空载转速(RPM) No load speed	1900	850	380	160	73	32	14	5	
输出扭矩(kg.cm) Output torque	0.4	0.7	1.4	2.5	5	6	6	6	
堵转扭矩(kg.cm) Stall torque	1.5	2.5	6	10	25	40	50	80	

备注 note:

1. 减速电机电压, 转速, 扭矩可在一定范围内定制; Voltage, speed and torque of gear motors can be customized within a certain range.
2. 部分减速电机可以加装编码器或刹车制动器; Encoder and brake are optional for some gear motors.
3. 减速电机可以正反转, 调速; Gear motors can rotate CW or CCW, and speed adjustable.
4. 扭矩 (扭力) 单位换算: 1N.m=10.2kg.cm=8.85lb.Inch=142.86oz.Inch.

接线示意图

Wiring diagram

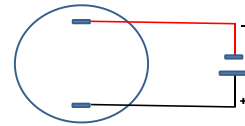
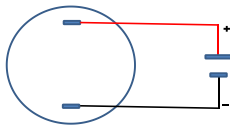

**电机外形尺寸 (Unit : mm)
Outline & Dimension**

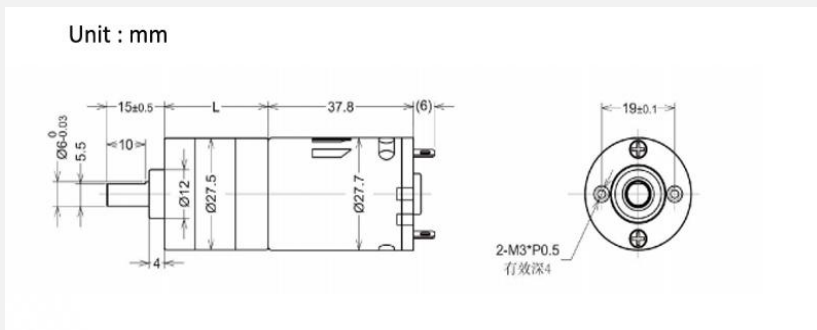

*尺寸图仅供参考, 减速箱的输出轴长, 轴径, 形状可以在一定范围内定制;

The drawing is for reference only, the shaft of gearbox can be customized within a certain range, such as the length, diameter and special shape.



42mm 7.5° geared stepper motor

42mm 直径7.5°齿轮减速步进电机

特点Features:

- *细分性能更优异Better performance under Subdivision mode
- *空载无细分步距角精度Step Angle Accuracy $\pm 5\%$ (full step, no load)
- *绝缘电阻Insulation Resistance 100M Ω Min, 500VDC
- *介电强度Dielectric Strength

应用Application:

精密仪器, 电子门锁, 数控设备
Precision meters, electric door-lock, digital-machinery



Model No.	Step Angle	Ratio	Current/phase	Frequency	Voltage	Holding Torque	Leads number	Weight
	($^{\circ}$)	(l)	(A)	(pps)	(V)	(kg.cm)	(No.)	(g)
BG42BS42M-30	7.5	30	0.4	300	12	5	2	220
BG42BS42M-50	7.5	50	0.4	300	12	8	2	220
BG42BS42M-120	7.5	120	0.4	300	12	20	2	220

备注 note:

- 1.电机不同的机身长度对应不同的静态扭矩; Different body length correspond to different holding torque.
- 2.步进电机可以加装编码器或刹车制动器; Encoder and brake are optional for certain stepper motors.
- 3.步进电机的出轴长度和形状、出线长度可以定制; Shaft length and shape, wire length can be customized.
- 4.扭矩(扭力)单位换算: 1N.m=10.2kg.cm=8.85lb.Inch=142.86oz.Inch.

接线示意图

Wiring diagram

TYPE OF CONNECTION (EXTERN)		MOTOR	
PIN NO	BIPOLAR	LEADS	WINDING
1	A —	BLK	A
2	A' —	GRN	A'
3	B —	RED	B
4	B' —	BLU	B'

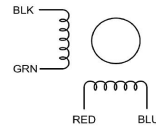

电机外形尺寸 (Unit : mm)

Outline & Dimension

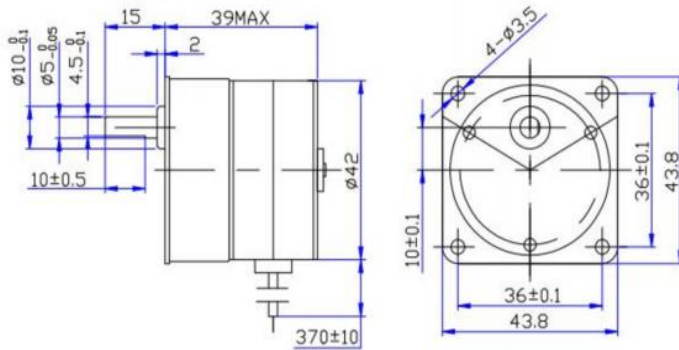

*尺寸图仅供参考, 减速箱的输出轴长, 轴径, 形状可以在一定范围内定制;

The drawing is for reference only, the shaft of gearbox can be customized within a certain range, such as the length, diameter and special shape.



BPM24D370

直流行星有刷减速电机 Planetary geared brushed dc motor

特点Features:

- *可靠耐用 Durable
- *长寿命 Long life time
- *效率高 High efficiency

应用Application:

搬运车, 轨道交通, 机器人, 农业机械, 太阳能设备
AGV, Rail Transport, Robot, Agricultural machine, Solar machinery



电机型号 Model of electric motor	D370									
电机类型 Motor structure	Brush PM									
额定电压 (V) Rated voltage	6					12				
空载电流 (mA) No load current	50					25				
空载转速 (RPM) No load speed	5500					5600				
额定电流 (mA) Rated current	300					170				
额定转速 (RPM) Rated speed	4750					4800				
额定扭力 (gf.cm) Rated torque	25					25				
额定功率 (W) Rated power	2.7					2.7				
堵转电流 (mA) Stall current	2.1					1.1				
堵转扭力 (gf.cm) Stall torque	190					190				
减速电机性能 Gear motor performance	BPM24D370 DC6V									
减速箱结构 Gear type	Planetary									
减速比 (i) Ratio	4	14	27	51	100	189	369	720		
空载转速 (RPM) No load speed	1350	390	200	108	55	29	15	7.5		
额定扭矩 (kgf.cm) Output torque	0.07	0.2	0.4	0.6	1.2	2	4	5		
堵转扭矩 (kgf.cm) Stall torque	0.5	1.6	3	5.5	10	15	15	20		
减速电机性能 Gear motor performance	BPM24D370 DC12V									
减速箱结构 Gear type	Planetary									
减速比 (i) Ratio	4	14	27	51	100	189	369	720		
空载转速 (RPM) No load speed	1400	400	205	110	56	30	15	7.8		
额定扭矩 (kgf.cm) Output torque	0.07	0.2	0.4	0.6	1.2	2	4	5		
堵转扭矩 (kgf.cm) Stall torque	0.5	1.6	3	5.5	10	15	15	20		

备注 note:

1. 减速电机电压, 转速, 扭矩可在一定范围内定制; Voltage, speed and torque of gear motors can be customized within a certain range.
2. 部分减速电机可以加装编码器或刹车制动器; Encoder and brake are optional for some gear motors.
3. 减速电机可以正反转, 调速; Gear motors can rotate CW or CCW, and speed adjustable.
4. 扭矩 (扭力) 单位换算: 1N.m=10.2kg.cm=8.85lb.inch=142.86oz.inch.

接线示意图

Wiring diagram

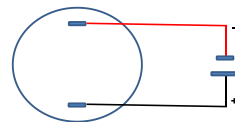
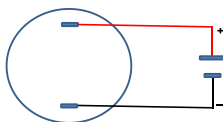

电机外形尺寸 (Unit : mm)
Outline & Dimension

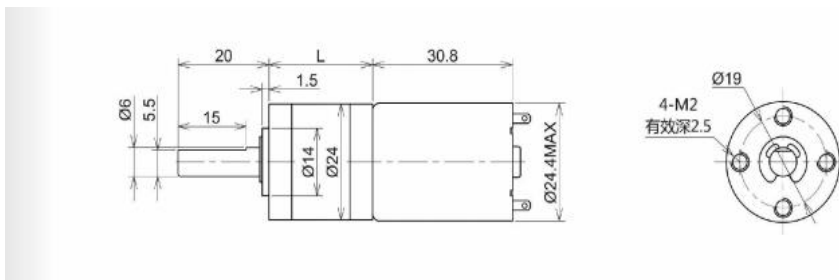

*尺寸图仅供参考, 减速箱的输出轴长, 轴径, 形状可以在一定范围内定制;

The drawing is for reference only, the shaft of gearbox can be customized within a certain range, such as the length, diameter and special shape.



Nema11 BS28 Series stepper motor

Nema11 BS28 系列步进电机

特点Features:

- *混合式结构 hybrid structure
- *额定电流下耐温升值 thermostability up to 80°C rise at rated current
- *细分性能更优异 Better performance under Subdivision mode
- *空载无细分步距角精度 Step Angle Accuracy $\pm 5\%$ (full step, no load)
- *绝缘电阻 Insulation Resistance 100M Ω Min , 500VDC
- *介电强度 Dielectric Strength

应用Application:

精密仪器, 电子门锁, 数控设备
Precision meters, electric door-lock, digital-machinery



Model No.	Step Angle	Ratio	Current/phase	Frequency	Speed	Holding Torque	Leads number	Weight
Single shaft / Double shaft	($^{\circ}$)	(L)mm	(A)	(pps)	(rpm)	(kg.cm)	(No.)	(g)
BP22BS28L32 (S) BP22BS28L32 (D)	1.8	5	0.67	2000	100	1.2	4/6	300
BP22BS28L32 (S) BP22BS28L32 (D)	1.8	20	0.67	2000	25	4	4/6	300
BP22BS28L32 (S) BP22BS28L32 (D)	1.8	27	0.67	2000	18	5	4/6	300
BP22BS28L32 (S) BP22BS28L32 (D)	1.8	50	0.67	2000	10	8	4/6	300
BP22BS28L32 (S) BP22BS28L32 (D)	1.8	70	0.67	2000	7	12	4/6	300
BP22BS28L32 (S) BP22BS28L32 (D)	1.8	100	0.67	2000	5	15	4/6	300

备注 note:

- 1.电机不同的机身长度对应不同的静态扭矩； Different body length correspond to different holding torque.
- 2.步进电机可以加装编码器或刹车制动器； Encoder and brake are optional for certain stepper motors.
- 3.步进电机的出轴长度和形状、出线长度可以定制； Shaft length and shape, wire length can be customized.
- 4.扭矩（扭力）单位换算：1N.m=10.2kg.cm=8.85lb.Inch=142.86oz.Inch.

接线示意图

Wiring diagram

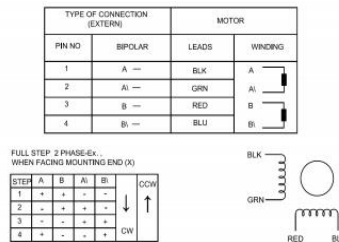

电机外形尺寸 (Unit : mm)

Outline & Dimension

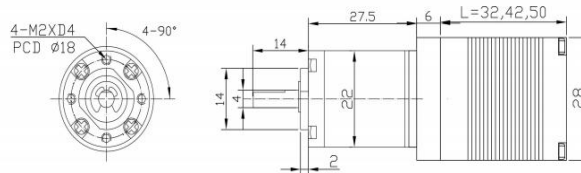

*尺寸图仅供参考，减速箱的输出轴长，轴径，形状可以在一定范围内定制；

The drawing is for reference only, the shaft of gearbox can be customized within a certain range, such as the length, diameter and special shape.



BPM22D180

直流有刷减速电机

Planetary gear brushed dc motor



特点Features:

- *有刷电机, 使用简单brush motor ,easy use.
- *正反转及调速方便Easy direction and speed control
- *可靠Reliable

应用Application:

搬运车, 轨道交通, 机器人, 农业机械, 太阳能设备, 道闸系统
AGV, Rail Transport, Robot, Agricultural machine, Solar machine, barrier gate system

电机型号 Model of electric motor	BPM22D180			
电机类型 Motor structure	Brushed PM			
额定电压(V) Rated voltage	12	24		
空载电流(mA) No load current	25	30		
空载转速(RPM) No load speed	4400	9600		
额定电流(mA) Rated current	90	140		
额定转速(RPM) Rated speed	3500	8500		
额定扭力(gf.cm) Rated torque	13	20		
额定功率(W) Rated power	0.5	1.8		
堵转电流(mA) Stall current	350	850		
堵转扭力(gf.cm) Stall torque	60	155		

减速电机性能 Gear motor performance	BPM22D180									
减速箱结构 Gear type	Planetary									
减速比(i) Ratio	16	62	84	104	231	316	370	455	1014	
空载转速(RPM) No load speed /DC 12V	250	70	51	44	19	14	12.5	9.5	4	
输出扭矩(kgf.cm) Output torque	0.125	0.51	0.63	0.8	1.86	2.43	2.91	3	3	
最大瞬时扭矩(kgf.cm) Max. torque	9.5									
重量(Kg) Weight	0.5									

备注 note:

- 1.减速电机电压, 转速, 扭矩可在一定范围内定制; Voltage, speed and torque of gear motors can be customized within a certain range.
- 2.部分减速电机可以加装编码器或刹车制动器; Encoder and brake are optional for some gear motors.
- 3.减速电机可以正反转, 调速; Gear motors can rotate CW or CCW, and speed adjustable.
- 4.扭矩 (扭力) 单位换算: 1N.m=10.2kg.cm=8.85lb.Inch=142.86oz.Inch.

接线示意图

Wiring diagram

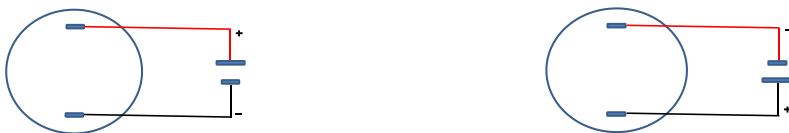

电机外形尺寸 (Unit : mm)

Outline & Dimension

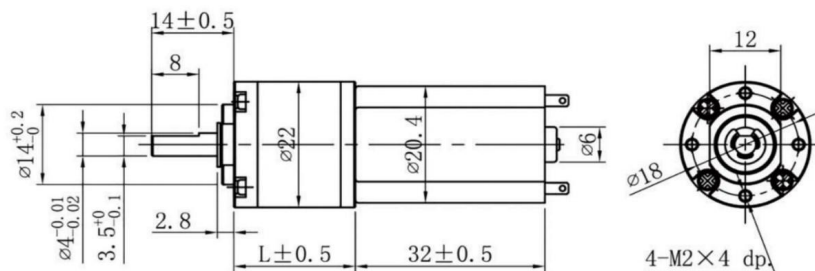

*尺寸图仅供参考, 减速箱的输出轴长, 轴径, 形状可以在一定范围内定制;

The drawing is for reference only, the shaft of gearbox can be customized within a certain range, such as the length, diameter and special shape.



BFM6095D555

直流有刷减速电机

Gear brushed dc motor

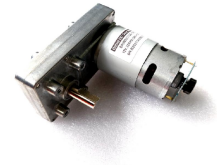

特点Features:

- *有刷电机, 使用简单brush motor ,easy use.
- *正反转及调速方便Easy direction and speed control
- *可靠Reliable

应用Application:

搬运车, 轨道交通, 机器人, 农业机械, 太阳能设备, 道闸系统
AGV, Rail Transport, Robot, Agricultural machine, Solar machine, barrier gate system

电机型号 Model of electric motor	BFM6095D555		
电机类型 Motor structure	Brushed PM		
额定电压(V) Rated voltage	6	12	24
空载电流(mA) No load current	858	171	320
空载转速(RPM) No load speed	6000	3000	8500
额定电流(mA) Rated current	2250	561	1500
额定转速(RPM) Rated speed	4500	2400	6450
额定扭力(gf.cm) Rated torque	300	126	300
额定功率(W) Rated power	13.8	3.2	20.3
堵转电流(mA) Stall current	10000	2390	6000
堵转扭力(gf.cm) Stall torque	1080	560	1120

减速电机性能 Gear motor performance	BFM6095D555							
减速箱结构 Gear type	Flat shape							
减速比(i) Ratio	26	81	135	207	394	405		
空载转速(RPM) No load speed /DC 24V	327	105	63	41	22	21		
输出扭矩(N.m) Output torque	0.6	1.9	3.2	5.0	9.5	9.7		
最大瞬时扭矩(kgf.cm) Max. torque	9.7							
重量(Kg) Weight	1							

备注 note:

- 1.减速电机电压, 转速, 扭矩可在一定范围内定制; Voltage, speed and torque of gear motors can be customized within a certain range.
- 2.部分减速电机可以加装编码器或刹车制动器; Encoder and brake are optional for some gear motors.
- 3.减速电机可以正反转、调速; Gear motors can rotate CW or CCW, and speed adjustable.
- 4.扭矩 (扭力) 单位换算: 1N.m=10.2kg.cm=8.85lb.Inch=142.86oz.Inch.

接线示意图

Wiring diagram



电机外形尺寸 (Unit : mm)

Outline & Dimension

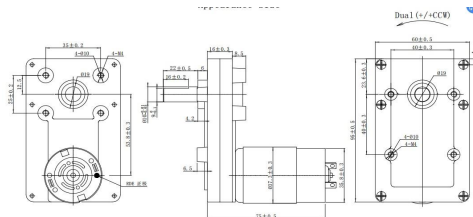

*尺寸图仅供参考, 减速箱的输出轴长, 轴径, 形状可以在一定范围内定制;

The drawing is for reference only, the shaft of gearbox can be customized within a certain range, such as the length, diameter and special shape.



BWGM70-Z76

直流有刷减速电机

Gear brushed dc motor

特点Features:

- *有刷电机, 使用简单brush motor ,easy use.
- *正反转及调速方便Easy direction and speed control
- *可靠Reliable

应用Application:

搬运车, 轨道交通, 机器人, 农业机械, 太阳能设备, 道闸系统
AGV,Rail Transport,Robot,Agricultural machine,Solar machine, barrier gate system



电机型号 Model of electric motor	BWGM70-Z76		
电机类型 Motor structure	Brushed PM		
额定电压(V) Rated voltage	12	24	36
空载电流(A) No load current	1.2	0.8	0.53
空载转速(RPM) No load speed	2000	2000	2000
额定电流(A) Rated current	10	5	3.4
额定转速(RPM) Rated speed	1500	1500	1500
额定扭力(N.m) Rated torque	0.4	0.4	0.4
额定功率(W) Rated power	120	120	120
堵转电流(mA) Stall current	/	/	/
堵转扭力(gf.cm) Stall torque	/	/	/
减速电机性能 Gear motor performance	BWGM70-Z76		
减速箱结构 Gear type	worm gear		
减速比(i) Ratio	20	60	75
空载转速(RPM) No load speed /DC 24V or 12V	100	33	28
输出扭矩(N.m) Output torque	6	16	18
最大瞬时扭矩(N.m) Max. torque		20	
重量(Kg) Weight		2.2	

备注 note:

- 1.减速电机电压, 转速, 扭矩可在一定范围内定制; Voltage,speed and torque of gear motors can be customized within a certain range.
- 2.部分减速电机可以加装编码器或刹车制动器; Encoder and brake are optional for some gear motors.
- 3.减速电机可以正反转、调速; Gear motors can rotate CW or CCW,and speed adjustable.
- 4.扭矩 (扭力) 单位换算: 1N.m=10.2kg.cm=8.85lb.Inch=142.86oz.Inch.

接线示意图

Wiring diagram



电机外形尺寸 (Unit : mm)

Outline & Dimension

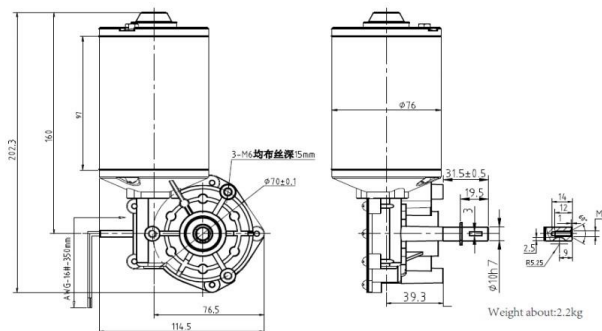

*尺寸图仅供参考, 减速箱的输出轴长, 轴径, 形状可以在一定范围内定制;

The drawing is for reference only,the shaft of gearbox can be customized within a certain range, such as the length,diameter and special shape.



BGM37EC3625

直流无刷减速电机

Spur gear brushless dc motor



特点Features:

- *无刷结构, 无摩擦, 低噪声, 寿命更长brushless structure, no contact, no friction, lower noise, longer life time than brushed.
- *无刷, 无接触电阻, 效率更高brushless, no contact resistance, no voltage loss, has higher efficiency
- *无积碳, 更可靠brushless, no carbon deposit, more reliable

应用Application:

搬运车, 轨道交通, 机器人, 数控设备, 农业, 办公设备, 工业设备, 军用设备
AGV, Rail Transport, Robot, Agricultural machine, CNC, Industrial machinery, military machinery

电机型号 Model of electric motor	BGM37EC3625												
电机类型 Motor structure	Brushless PM												
额定电压(V) Rated voltage	12						24						
空载电流(mA) No load current	90						60						
空载转速(RPM) No load speed	6500						6500						
额定电流(mA) Rated current	280						160						
额定转速(RPM) Rated speed	5300						5300						
额定扭力(gf.cm) Rated torque	50						50						
额定功率(W) Rated power	1.9						1.9						
堵转电流(A) Stall current	1.25						0.65						
堵转扭力(gf.cm) Stall torque	280						310						
减速电机性能 Gear motor performance	BGM37EC3625												
减速箱结构 Gear type	Spur												
减速比(i) Ratio	6	10	30	44	56	90	169	270	506	810			
空载转速(RPM) No load speed /DC 12V	1000	630	210	145	115	70	38	24	13	8			
输出扭矩(kgf.cm) Output torque	0.25	0.4	1.1	1.5	2	2.6	4	6	10	10			
最大瞬时扭矩(kgf.cm) Max. torque	10												
重量(Kg) Weight	1												

备注 note:

1. 减速电机电压, 转速, 扭矩可在一定范围内定制 Voltage, speed and torque of gear motors can be customized within a certain range.
2. 部分减速电机可以加装编码器或刹车制动器 Encoder and brake are optional for some gear motors.
3. 减速电机可以正反转 调速: Gear motors can rotate CW or CCW, and speed adjustable.
4. 扭矩 (扭力) 单位换算: 1N.m=10.2kg.cm=8.85lb.Inch=142.86oz.Inch.

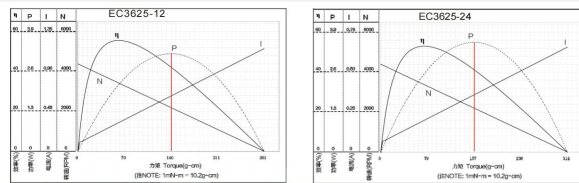

**电机外形尺寸 (Unit : mm)
Outline & Dimension**

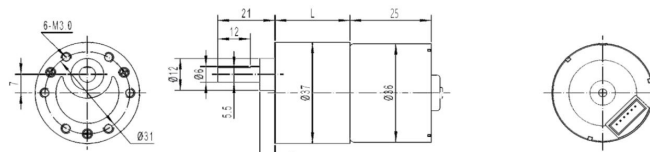

Weight: 300g(Approx)

Unit(mm)

*尺寸图仅供参考, 减速箱的输出轴长, 轴径, 形状可以在一定范围内定制

The drawing is for reference only, the shaft of gearbox can be customized within a certain range, such as the length, diameter and special shape.



RV30ZD9020

直流有刷减速电机

Worm gear brushed dc motor



特点Features:

- *有刷电机, 使用简单brush motor ,easy use.
- *正反转及调速方便Easy direction and speed control
- *可靠Reliable

应用Application:

搬运车, 轨道交通, 机器人, 农业机械, 太阳能设备, 道闸系统
AGV, Rail Transport, Robot, Agricultural machine, Solar machine, barrier gate system

电机型号 Model of electric motor	ZD9020		
电机类型 Motor structure	Brushed PM		
额定电压(V) Rated voltage	24	36	48
空载电流(A) No load current	2	1	0.6
空载转速(RPM) No load speed	2000	2000	2000
额定电流(A) Rated current	15	10	8
额定转速(RPM) Rated speed	1800	1800	1800
额定扭力(Kg.cm) Rated torque	11.8	19	11.8
额定功率(W) Rated power	300	300	300
堵转电流(A) Stall current	30	25	20
堵转扭力(Kg.cm) Stall torque	20	22	33

减速电机性能 Gear motor performance	RV30ZD9020												
减速箱结构 Gear type	worm												
减速比(i) Ratio	5	7.5	10	15	20	25	30	40	50	60	80	100	
空载转速(RPM) No load speed	3000	2200	1600	1200	900	500	380	220	150	120	150	120	
输出扭矩(N.m) Output torque	1	2	3	4	5	6	7	8	9	10	9	10	
最大瞬时扭矩(N.m) Max. torque	20												
重量(Kg) Weight	0.5												

备注 note:

1. 减速电机电压, 转速, 扭矩可在一定范围内定制; Voltage, speed and torque of gear motors can be customized within a certain range.
2. 部分减速电机可以加装编码器或刹车制动器; Encoder and brake are optional for some gear motors.
3. 减速电机可以正反转、调速; Gear motors can rotate CW or CCW, and speed adjustable.
4. 扭矩 (扭力) 单位换算: 1N.m=10.2kg.cm=8.85lb.Inch=142.86oz.Inch.

接线示意图

Wiring diagram



电机外形尺寸 (Unit : mm)

Outline & Dimension

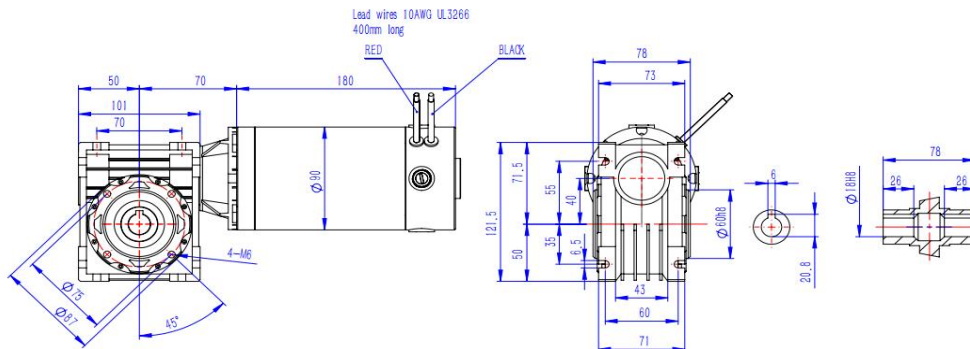

*尺寸图仅供参考, 减速箱的输出轴长, 轴径, 形状可以在一定范围内定制;

The drawing is for reference only, the shaft of gearbox can be customized within a certain range, such as the length, diameter and special shape.



BZD76F

直流有刷纯电机 Brushed dc motor



特点Features:

- *有刷电机, 使用简单brush motor ,easy use.
- *正反转及调速方便Easy direction and speed control
- *可靠Reliable

应用Application:

搬运车, 轨道交通, 机器人, 农业机械, 太阳能设备, 道闸系统
AGV, Rail Transport, Robot, Agricultural machine, Solar machine, barrier gate system

电机型号 Model of electric motor	BZD76F		
电机类型 Motor structure	Brushed PM		
额定电压(V) Rated voltage	12	24	
空载电流(A) No load current	0.95	0.9	
空载转速(RPM) No load speed	4460	4484	
额定电流(A) Rated current	18	8.9	
额定转速(RPM) Rated speed	3120	3162	
额定扭力(Kg.cm) Rated torque	2	2	
额定功率(W) Rated power	125	133	
堵转电流(A) Stall current	10	5.1	
堵转扭力(Kg.cm) Stall torque	4	4	
减速电机性能 Gear motor performance			
减速箱结构 Gear type			
减速比(i) Ratio			
空载转速(RPM) No load speed			
输出扭矩(N.m) Output torque			
最大瞬时扭矩(N.m) Max. torque			
重量(Kg) Weight	1		

备注 note:

1. 减速电机电压, 转速, 扭矩可在一定范围内定制; Voltage, speed and torque of gear motors can be customized within a certain range.
2. 部分减速电机可以加装编码器或刹车制动器; Encoder and brake are optional for some gear motors.
3. 减速电机可以正反转、调速; Gear motors can rotate CW or CCW, and speed adjustable.
4. 扭矩 (扭力) 单位换算: 1N.m=10.2kg.cm=8.85lb.Inch=142.86oz.Inch.

接线示意图

Wiring diagram



电机外形尺寸 (Unit: mm)

Outline & Dimension

Model: BZD76F

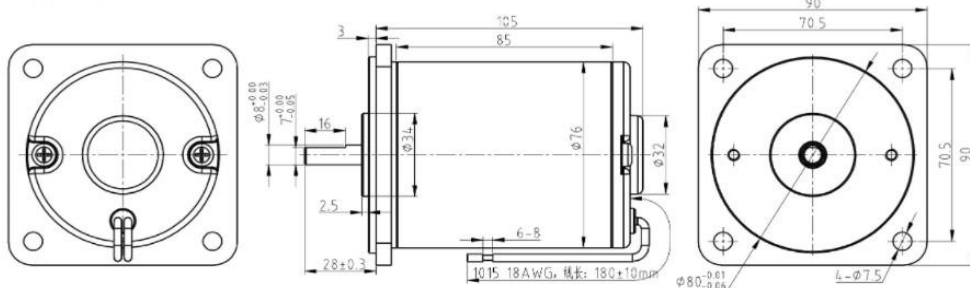

*尺寸图仅供参考, 减速箱的输出轴长, 轴径, 形状可以在一定范围内定制;

The drawing is for reference only, the shaft of gearbox can be customized within a certain range, such as the length, diameter and special shape.



W22-D370

直流有刷减速电机

Worm gear brushed dc motor



特点Features:

- *有刷电机, 使用简单brush motor ,easy use.
- *正反转及调速方便Easy direction and speed control
- *可靠Reliable

应用Application:

搬运车, 轨道交通, 机器人, 农业机械, 太阳能设备, 道闸系统
AGV, Rail Transport, Robot, Agricultural machine, Solar machine, barrier gate system

电机型号 Model of electric motor	D370										
电机类型 Motor structure	Brushed PM										
额定电压(V) Rated voltage	6			12				24			
空载电流(A) No load current	0.05			0.025				0.0125			
空载转速(RPM) No load speed	5600			5600				5600			
额定电流(A) Rated current	0.3			0.16				0.08			
额定转速(RPM) Rated speed	4800			4800				4800			
额定扭力(Kg.cm) Rated torque	0.024			0.024				0.024			
额定功率(W) Rated power	1.18			1.18				1.18			
堵转电流(A) Stall current	2.1			1				0.3			
堵转扭力(Kg.cm) Stall torque	0.186			0.186				0.186			
减速电机性能 Gear motor performance	W22-D370										
减速箱结构 Gear type	worm										
减速比(i) Ratio	146	188	300	438	563	700	900	1020	1313	1688	
空载转速(RPM) at 6v No load speed	38	30	19	12	10	8	6	5	4	3	
输出扭矩(N.m) Output torque	1.65	1.65	1.65	1.65	1.65	1.65	1.65	1.65	1.65	1.65	
最大瞬时扭矩(N.m) Max. torque	1.65										
重量(Kg) Weight	1										

备注 note:

- 1.减速电机电压, 转速, 扭矩可在一定范围内定制; Voltage, speed and torque of gear motors can be customized within a certain range.
- 2.部分减速电机可以加装编码器或刹车制动器; Encoder and brake are optional for some gear motors.
- 3.减速电机可以正反转、调速; Gear motors can rotate CW or CCW, and speed adjustable.
- 4.扭矩 (扭力) 单位换算: 1N.m=10.2kg.cm=8.85lb.Inch=142.86oz.Inch.

接线示意图

Wiring diagram



电机外形尺寸 (Unit : mm)

Outline & Dimension

外形尺寸/Appearance dimension(mm)

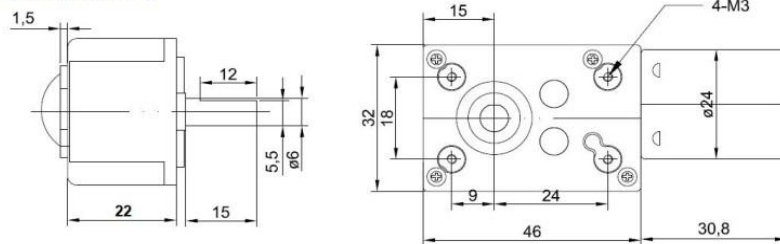

*尺寸图仅供参考, 减速箱的输出轴长, 轴径, 形状可以在一定范围内定制;

The drawing is for reference only, the shaft of gearbox can be customized within a certain range, such as the length, diameter and special shape.



W28-D555

直流有刷减速电机

Worm gear brushed dc motor

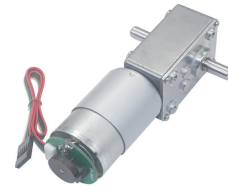

特点Features:

- *有刷电机, 使用简单brush motor ,easy use.
- *正反转及调速方便Easy direction and speed control
- *可靠Reliable

应用Application:

搬运车, 轨道交通, 机器人, 农业机械, 太阳能设备, 道闸系统
AGV, Rail Transport, Robot, Agricultural machine, Solar machine, barrier gate system

电机型号 Model of electric motor	D555						
电机类型 Motor structure	Brushed PM						
额定电压(V) Rated voltage	12				12		
空载电流(A) No load current	0.22				0.3		
空载转速(RPM) No load speed	6000				9000		
额定电流(A) Rated current	0.5				0.8		
额定转速(RPM) Rated speed	5700				8500		
额定扭力(Kg.cm) Rated torque	0.24				0.21		
额定功率(W) Rated power	14				18		
堵转电流(A) Stall current	3.4				4.2		
堵转扭力(Kg.cm) Stall torque	2.25				1.18		
减速电机性能 Gear motor performance	W28-D555						
减速箱结构 Gear type	worm						
减速比(i) Ratio	26		81		135		207
空载转速(RPM) at 12v No load speed	230		74		44		29
输出扭矩(N.m) Output torque	0.61		1.8		1.9		1.9
最大瞬时扭矩(N.m) Max. torque	3						
重量(Kg) Weight	1						

备注 note:

1. 减速电机电压, 转速, 扭矩可在一定范围内定制; Voltage, speed and torque of gear motors can be customized within a certain range.
2. 部分减速电机可以加装编码器或刹车制动器; Encoder and brake are optional for some gear motors.
3. 减速电机可以正反转、调速; Gear motors can rotate CW or CCW, and speed adjustable.
4. 扭矩 (扭力) 单位换算: 1N.m=10.2kg.cm=8.85lb.Inch=142.86oz.Inch.

接线示意图

Wiring diagram



电机外形尺寸 (Unit : mm)

Outline & Dimension

外形尺寸/Appearance dimension(mm)

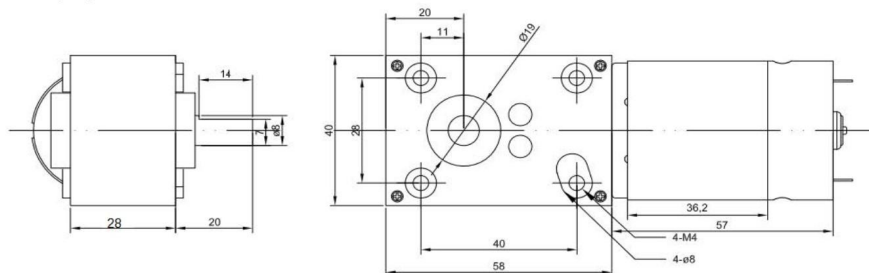

*尺寸图仅供参考, 减速箱的输出轴长, 轴径, 形状可以在一定范围内定制;

The drawing is for reference only, the shaft of gearbox can be customized within a certain range, such as the length, diameter and special shape.



BGM28D365

直流有刷减速电机

Planetary gear brushed dc motor



特点Features:

- *有刷电机, 使用简单brush motor ,easy use.
- *正反转及调速方便Easy direction and speed control
- *可靠Reliable

应用Application:

搬运车, 轨道交通, 机器人, 农业机械, 太阳能设备, 道闸系统
AGV, Rail Transport, Robot, Agricultural machine, Solar machine, barrier gate system

电机型号 Model of electric motor	D365		
电机类型 Motor structure	Brushed PM		
额定电压(V) Rated voltage	12	12	
空载电流(A) No load current	70	150	
空载转速(RPM) No load speed	7300	11000	
额定电流(A) Rated current	270	1100	
额定转速(RPM) Rated speed	6400	7300	
额定扭力(Kg.cm) Rated torque	30	80	
额定功率(W) Rated power	4.6	8.5	
堵转电流(A) Stall current	1600	2900	
堵转扭力(Kg.cm) Stall torque	240	300	

减速电机性能 Gear motor performance	BGM28D365-1273 DC12V									
减速箱结构 Gear type	Planetary									
减速比(i) Ratio	5.7	13	29	67	152	345	792	2139		
空载转速(RPM) No load speed	1920	850	380	160	72	32	14	5		
输出扭矩(N.m) Output torque	0.03	0.05	0.12	0.25	0.45	0.6	0.6	0.6		
最大瞬时扭矩(N.m) Max. torque	8									
重量(Kg) Weight	0.5									

备注 note:

- 1.减速电机电压, 转速, 扭矩可在一定范围内定制; Voltage, speed and torque of gear motors can be customized within a certain range.
- 2.部分减速电机可以加装编码器或刹车制动器; Encoder and brake are optional for some gear motors.
- 3.减速电机可以正反转, 调速; Gear motors can rotate CW or CCW, and speed adjustable.
- 4.扭矩 (扭力) 单位换算: 1N.m=10.2kg.cm=8.85lb.Inch=142.86oz.Inch.

接线示意图

Wiring diagram



电机外形尺寸 (Unit : mm)

Outline & Dimension

Unit : mm

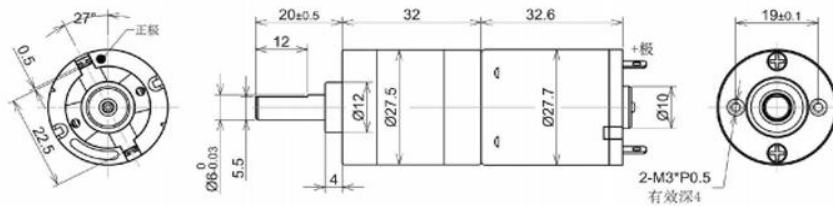

*尺寸图仅供参考, 减速箱的输出轴长, 轴径, 形状可以在一定范围内定制;

The drawing is for reference only, the shaft of gearbox can be customized within a certain range, such as the length, diameter and special shape.



BGM37D555

直流有刷减速电机

Spur gear brushed dc motor



特点Features:

- *有刷电机, 使用简单brush motor ,easy use.
- *正反转及调速方便Easy direction and speed control
- *可靠Reliable

应用Application:

搬运车, 轨道交通, 机器人, 农业机械, 太阳能设备, 道闸系统
AGV, Rail Transport, Robot, Agricultural machine, Solar machine, barrier gate system

电机型号 Model of electric motor	BGM37D555										
电机类型 Motor structure	Brushed PM										
额定电压(V) Rated voltage	12					24					
空载电流(A) No load current	0.2					0.3					
空载转速(RPM) No load speed	3300					8000					
额定电流(A) Rated current	1					1.6					
额定转速(RPM) Rated speed	2800					7150					
额定扭力(Kg.cm) Rated torque	0.2					0.26					
额定功率(W) Rated power	5.7					8.4					
堵转电流(A) Stall current	5.5					5.7					
堵转扭力(Kg.cm) Stall torque	1.15					1.5					

减速电机性能 Gear motor performance	BGM37D555											
减速箱结构 Gear type	spur											
减速比(i) Ratio	6	10	19	30	56	90	169	270	506	810		
空载转速(RPM) No load speed	550	320	160	110	58	40	28	13	7	4.5		
输出扭矩(N.m) Output torque	0.56	0.93	1.6	1.6	1.6	1.6	1.6	1.6	1.6	1.6		
最大瞬时扭矩(N.m) Max. torque	1.6											
重量(Kg) Weight	0.5											

备注 note:

1. 减速电机电压, 转速, 扭矩可在一定范围内定制; Voltage, speed and torque of gear motors can be customized within a certain range.
2. 部分减速电机可以加装编码器或刹车制动器; Encoder and brake are optional for some gear motors.
3. 减速电机可以正反转、调速; Gear motors can rotate CW or CCW and speed adjustable.
4. 扭矩 (扭力) 单位换算: 1N.m=10.2kg.cm=8.85lb.Inch=142.86oz.Inch.

接线示意图

Wiring diagram



电机外形尺寸 (Unit: mm)

Outline & Dimension

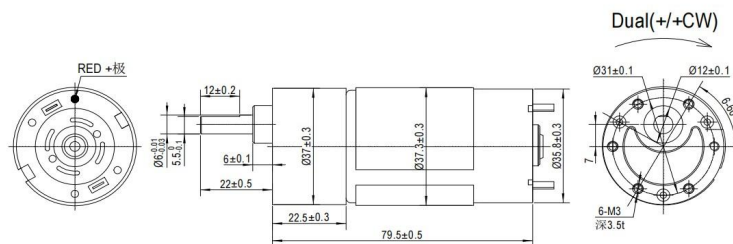

*尺寸图仅供参考, 减速箱的输出轴长, 轴径, 形状可以在一定范围内定制;

The drawing is for reference only, the shaft of gearbox can be customized within a certain range, such as the length, diameter and special shape.



Nema17 (42mm width) BS42 Series stepper motor

Nema17 (42mm width) BS42系列步进电机

特点 Features:

- *混合式结构 hybrid structure
- *额定电流下耐温升值 thermostability up to 80°C rise at rated current
- *细分性能更优异 Better performance under Subdivision mode
- *空载无细分步距角精度 Step Angle Accuracy $\pm 5\%$ (full step, no load)
- *绝缘电阻 Insulation Resistance 100M Ω Min., 500VDC
- *介电强度 Dielectric Strength

应用 Application:

精密仪器, 电子门锁, 数控设备
Precision meters, electric door-lock, digital-machinery



Model No.	Step Angle	Motor Length	Rated Current	Phase Resistance	Phase Inductance	Holding Torque	Inertia Of Rotor	Leads number	Weight
Single shaft / Double shaft	($^{\circ}$)	(L)mm	(A)	(Ω)	(mH)	(N.m)	(G. cm 2)	(No.)	(g)
BS42L34 (S) BS42L34D	1.8	34	1	3.5	6	0.3	38	4	350
BS42L40 (S) BS42L40D	1.8	40	1.8	3.5	6	0.4	38	4	350
BS42L48 (S) BS42L48D	1.8	48	2	3.5	6	0.6	38	4	350
BS42L60 (S) BS42L60D	1.8	60	2.2	3.5	6	0.8	38	4	350

减速电机性能

Gear motor performance

W28BS42L40

减速箱结构

worm / planetary / spur

Gear type

减速比(i)

Ratio

空载转速 (RPM)

No load speed

输出扭矩 (N.m)

Output torque

最大瞬时扭矩 (N.m)

Max. torque

重量 (Kg)

Weight

备注 note:

- 1.电机不同的机身长度对应不同的静态扭矩； Different body length correspond to different holding torque.
- 2.步进电机可以加装编码器或刹车制动装置； Encoder and brake are optional for certain stepper motors.
- 3.步进电机的出轴长度和形状、出线长度可以定制； Shaft length and shape,wire length can be customized.
- 4.扭矩（扭力）单位换算：1N.m=10.2kg.cm=8.85lb.Inch=142.86oz.Inch.

接线示意图

Wiring diagram

TYPE OF CONNECTION (EXTERN)		MOTOR	
PIN NO	BIPOLAR	LEADS	WINDING
1	A	BLK	A
2	A'	GRN	A'
3	B	RED	B
4	B'	BLU	B'

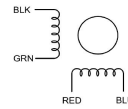

电机外形尺寸 (Unit: mm)

Outline & Dimension

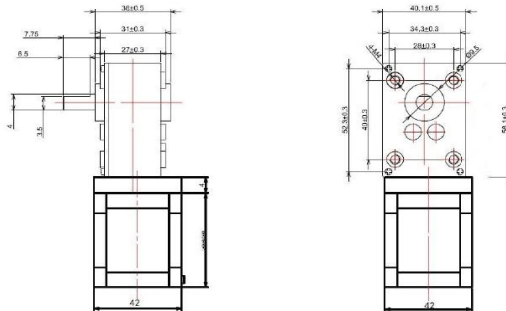

*尺寸图仅供参考，减速箱的输出轴长、轴径、形状可以在一定范围内定制；

The drawing is for reference only,the shaft of gearbox can be customized within a certain range, such as the length,diameter and special shape.



Gear PM stepper motor 28BYJ48

永磁式减速步进电机

特点 Features:

- *混合式结构 hybrid structure
- *额定电流下耐温升值 thermostability up to 80°C rise at rated current
- *细分性能更优异 Better performance under subdivision mode
- *空载无细分步距角精度 Step Angle Accuracy $\pm 5\%$ (full step, no load)
- *绝缘电阻 Insulation Resistance 100M Ω Min., 500VDC
- *介电强度 Dielectric Strength

应用 Application:

精密仪器, 电子门锁, 数控设备
Precision meters, electric door-lock, digital-machinery

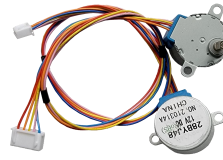

Model No.	Step Angle	Rated voltage	Phase No.	Drive	To turn to
Single shaft / Double shaft	(°)	(V)	/	/	/
28BYJ48	5.625	12	4	4-PH 8 Step	/
24BYJ48	5.625	5或12	/	4-PH 8 Step	CW/CCW

减速电机性能 Gear motor performance	24BYJ48				
减速箱结构 Gear type	worm / planetary / spur				
减速比(i) when the voltage is 12v Ratio	16	32	64	96	
空载转速 (RPM) No load speed	48	24	12	8	
输出扭矩 (N.m) Output torque	0.035	0.06	0.085	0.13	
最大瞬时扭矩 (N.m) Max. torque	0.13				
重量 (Kg) Weight	0.5				

备注 note:

- 电机不同的机身长度对应不同的静态扭矩； Different body length correspond to different holding torque.
- 步进电机可以加装编码器或刹车制动装置； Encoder and brake are optional for certain stepper motors.
- 步进电机的出轴长度和形状、出线长度可以定制； Shaft length and shape, wire length can be customized.
- 扭矩 (扭力) 单位换算： 1N.m=10.2kg.cm=8.85lb.Inch=142.86oz.Inch.

接线示意图 Wiring diagram

1-2相励磁顺序表

励磁端 序号	导线 颜色	1	2	3	4	5	6	7	8
5	红	+	+	+	+	+	+	+	+
4	橙	-	-	-	-	-	-	-	-
3	黄	-	-	-	-	-	-	-	-
2	粉	-	-	-	-	-	-	-	-
1	蓝	-	-	-	-	-	-	-	-

接线示意图:



轴伸端视之--逆时针方向

电机外形尺寸 (Unit: mm)
Outline & Dimension

Outline (外形图):

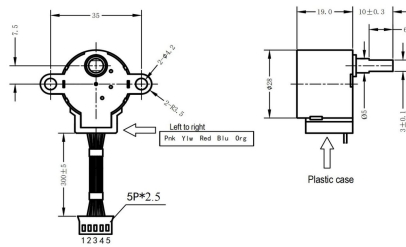

*尺寸图仅供参考, 减速箱的输出轴长、轴径、形状可以在一定范围内定制;

The drawing is for reference only, the shaft of gearbox can be customized within a certain range, such as the length, diameter and special shape.



Nema17 (42mm width) BS42 Series stepper motor

Nema17 (42mm width) BS42系列步进电机

特点 Features:

- *混合式结构 hybrid structure
- *额定电流下耐温升值 thermostability up to 80°C rise at rated current
- *细分性能更优异 Better performance under subdivision mode
- *空载无细分步距角精度 Step Angle Accuracy $\pm 5\%$ (full step, no load)
- *绝缘电阻 Insulation Resistance 100M Ω Min., 500VDC
- *介电强度 Dielectric Strength

应用 Application:

精密仪器, 电子门锁, 数控设备
Precision meters, electric door-lock, digital-machinery



Model No.	Step Angle	Encoder available	Dielectric Strength	Max. axial force	Max. axial force
Single shaft / Double shaft	($^{\circ}$)	/	VAC	N	N
	1.8	with encoder	500	600	300

减速电机性能 Gear motor performance	W28-BS42L40					
减速箱结构 Gear type	worm					
减速比 (i) Ratio	12	20	40	70	108	200
负载转速 (RPM) Rated speed	50	30	15	8	6	3
输出扭矩 (N.m) Output torque	2	5	5	5	5	5
最大瞬时扭矩 (N.m) Max. torque						5
重量 (Kg) Weight						1

备注 note:

- 电机不同的机身长度对应不同的静态扭矩； Different body length correspond to different holding torque.
- 步进电机可以加装编码器或刹车制动器； Encoder and brake are optional for certain stepper motors.
- 步进电机的出轴长度和形状、出线长度可以定制； Shaft length and shape, wire length can be customized.
- 扭矩（扭力）单位换算：1N.m=10.2kg.cm=8.85lb.Inch=142.86oz.Inch.

接线示意图

Wiring diagram

PIN NO	TYPE OF CONNECTION (EXTERN)		MOTOR	
	BIPOLAR	LEADS	WINDING	
1	A	BLK	A	
2	A'	GRN	A'	
3	B	RED	B	
4	B'	BLU	B'	

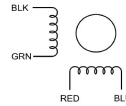

电机外形尺寸 (Unit : mm)

Outline & Dimension

尺寸图/Geared stepper motor dimension

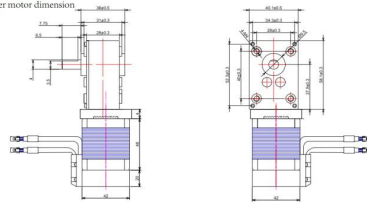

*尺寸图仅供参考，减速箱的输出轴长，轴径，形状可以在一定范围内定制；

The drawing is for reference only, the shaft of gearbox can be customized within a certain range, such as the length, diameter and special shape.



Nema23 (57mm width) BS57 Series stepper motor

Nem23 (57mm width) BS57系列步进电机

特点Features:

- *混合式结构 hybrid structure
- *额定电流下耐温升值 thermostability up to 80°C rise at rated current
- *细分性能更优异 Better performance under Subdivision mode
- *空载无细分步距角精度 Step Angle Accuracy $\pm 5\%$ (full step, no load)
- *绝缘电阻 Insulation Resistance 100M Ω Min, 500VDC
- *介电强度 Dielectric Strength

应用Application:

精密仪器, 电子门锁, 数控设备
Precision meters, electric door-lock, digital-machinery



Model No.	Step Angle	Motor Length	Rated Current	Phase Resistance	Phase Inductance	Holding Torque	Input Voltage	Weight
Single shaft / Double shaft	($^{\circ}$)	(L)mm	(A)	(Ω)	(mH)	(N.m)	(VDC)	(g)
BS57L41 (S) BS57L41 D	1.8	41+31	2.2	/	/	1.8	24-48	350
BS57L76 (S) BS57L76D	1.8	76+31	2.5	/	/	2.2	24-48	350
BS57L82 (S) BS57L82 D	1.8	82+31	3	/	/	2.5	24-48	350
BS57L112 (S) BS57L112 D	1.8	112+31	4	/	/	3	24-48	350

减速电机性能 Gear motor performance		PX57-BS57L76						
减速箱结构 Gear type		planetary						
减速比(i) Ratio	3	10	20	30	50	100		
输出转速(RPM) Output speed	100	30	15	10	6	3		
输出扭矩(N.m) Output torque	6	20	40	60	100	100		
最大瞬时扭矩(N.m) Max. torque				100				
重量(Kg) Weight				3				

备注 note:

- 电机不同的机身长度对应不同的静态扭矩； Different body length correspond to different holding torque.
- 步进电机可以加装编码器或刹车制动器； Encoder and brake are optional for certain stepper motors.
- 步进电机的出轴长度和形状、出线长度可以定制； Shaft length and shape, wire length can be customized.
- 扭矩（扭力）单位换算：1N.m=10.2kg.cm=8.85lb.inch=142.86oz.inch.

接线示意图 Wiring diagram

TYPE OF CONNECTION (EXTERN)		MOTOR	
PIN NO	BIPOLAR	LEADS	WINDING
1	A —	BLK	A
2	A1 —	GRN	A1
3	B —	RED	B
4	B1 —	BLU	B1

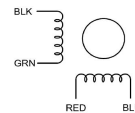

电机外形尺寸 (Unit : mm) Outline & Dimension

Nema 23 closed loop stepper motor Integrated driver version, 2Nm torque

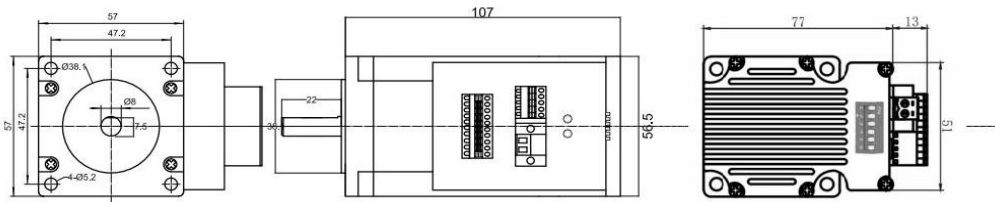

*尺寸图仅供参考, 减速箱的输出轴长、轴径、形状可以在一定范围内定制；

The drawing is for reference only, the shaft of gearbox can be customized within a certain range, such as the length, diameter and special shape.



RV30ZD9020

直流有刷减速电机

Worm gear brushed dc motor



特点Features:

- *有刷电机, 使用简单brush motor ,easy use.
- *正反转及调速方便Easy direction and speed control
- *可靠Reliable

应用Application:

搬运车, 轨道交通, 机器人, 农业机械, 太阳能设备, 道闸系统
AGV, Rail Transport, Robot, Agricultural machine, Solar machine, barrier gate system

电机型号 Model of electric motor	ZD9020		
电机类型 Motor structure	Brushed PM		
额定电压(V) Rated voltage	24	36	48
空载电流(A) No load current	2	1	0.6
空载转速(RPM) No load speed	2000	2000	2000
额定电流(A) Rated current	15	10	8
额定转速(RPM) Rated speed	1800	1800	1800
额定扭力(Kg.cm) Rated torque	11.8	19	11.8
额定功率(W) Rated power	300	300	300
堵转电流(A) Stall current	30	25	20
堵转扭力(Kg.cm) Stall torque	20	22	33

减速电机性能 Gear motor performance	RV30ZD9020												
减速箱结构 Gear type	worm												
减速比(i) Ratio	5	7.5	10	15	20	25	30	40	50	60	80	100	
空载转速(RPM) No load speed	3000	2200	1600	1200	900	500	380	220	150	120	150	120	
输出扭矩(N.m) Output torque	1	2	3	4	5	6	7	8	9	10	9	10	
最大瞬时扭矩(N.m) Max. torque	20												
重量(Kg) Weight	0.5												

备注 note:

- 1.减速电机电压, 转速, 扭矩可在一定范围内定制; Voltage, speed and torque of gear motors can be customized within a certain range.
- 2.部分减速电机可以加装编码器或刹车制动器; Encoder and brake are optional for some gear motors.
- 3.减速电机可以正反转、调速; Gear motors can rotate CW or CCW, and speed adjustable.
- 4.扭矩(扭力) 单位换算: 1N.m=10.2kg.cm=8.85lb.Inch=142.86oz.Inch.

接线示意图

Wiring diagram



电机外形尺寸 (Unit : mm)

Outline & Dimension

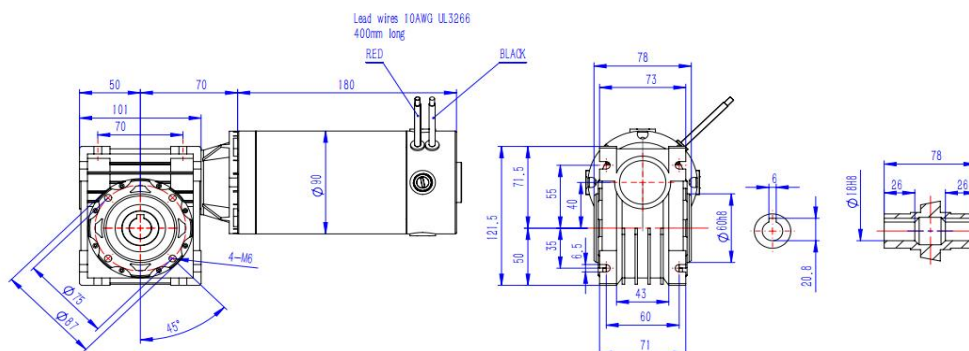

*尺寸图仅供参考, 减速箱的输出轴长, 轴径, 形状可以在一定范围内定制;

The drawing is for reference only, the shaft of gearbox can be customized within a certain range, such as the length, diameter and special shape.



BLF42

直流无刷减速电机

Planetary gear brushless dc motor



特点Features:

*无刷结构, 无摩擦, 低噪声, 寿命更长brushless structure,no contact, no friction ,lower noise,longer life time than brushed.
*无刷,无接触电阻, 效率更高brushless,no contact resistance,no voltage loss, has higher efficiency
*无积碳, 更可靠brushless,no carbon deposit,more reliable

应用Application:

搬运车, 轨道交通, 机器人, 数控设备, 农业, 办公设备, 工业设备, 军用设备
AGV,Rail Transport,Robot,Agricultural machine, CNC,Industrial machinery,military machinery

电机型号 Model of electric motor	BLF4240			
电机类型 Motor structure	Brushless PM			
额定电压(V) Rated voltage	12	24		
空载电流(A) No load current	/	/		
空载转速(RPM) No load speed	/	/		
额定电流(A) Rated current	/	/		
额定转速(RPM) Rated speed	4000	4000		
额定扭力(Kg.cm) Rated torque	0.625	0.625		
额定功率(W) Rated power	26	26		
堵转电流(A) Stall current	/	/		
堵转扭力(Kg.cm) Stall torque	/	/		
减速电机性能 Gear motor performance	no data			
减速箱结构 Gear type				
减速比(i) Ratio				
空载转速(RPM) No load speed				
输出扭矩(N.m) Output torque				
最大瞬时扭矩(N.m) Max. torque				
重量(Kg) Weight	1			

备注 note:

- 1.减速电机电压, 转速, 扭矩可在一定范围内定制; Voltage,speed and torque of gear motors can be customized within a certain range.
- 2.部分减速电机可以加装编码器或刹车制动器; Encoder and brake are optional for some gear motors.
- 3.减速电机可以正反转、调速; Gear motors can rotate CW or CCW,and speed adjustable.
- 4.扭矩 (扭力) 单位换算: 1N.m=10.2kg.cm=8.85lb.Inch=142.86oz.Inch.

接线示意图

Wiring diagram

A:
no driver-
inside:

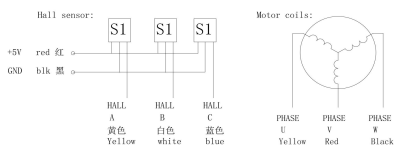

B:
driver-
inside:

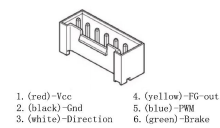

电机外形尺寸 (Unit : mm)

Outline & Dimension

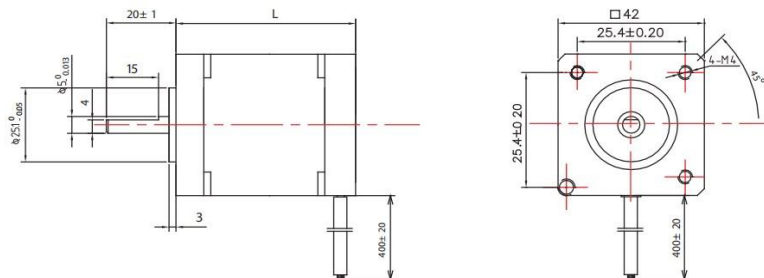

*尺寸图仅供参考, 减速箱的输出轴长, 轴径, 形状可以在一定范围内定制;

The drawing is for reference only,the shaft of gearbox can be customized within a certain range, such as the length,diameter and special shape.



BVM26D300

直流无刷减速电机 微型推杆电机 Gear brushless dc motor

特点Features:

*无刷结构, 无摩擦, 低噪声, 寿命更长brushless structure,no contact, no friction ,lower noise,longer life time than brushed.
*无刷,无接触电阻, 效率更高brushless,no contact resistance,no voltage loss, has higher efficiency
*无积碳, 更可靠brushless,no carbon deposit,more reliable

应用Application:

搬运车, 轨道交通, 机器人, 数控设备, 农业, 办公设备, 工业设备, 军用设备
AGV,Rail Transport,Robot,Agricultural machine, CNC,Industrial machinery,military machinery



电机型号 Model of electric motor	BVM26D300		
电机类型 Motor structure	Brushless PM		
额定电压(V) Rated voltage	2.2		
空载电流(A) No load current	0.022		
空载转速(RPM) No load speed	3100		
额定电流(A) Rated current	0.09		
额定转速(RPM) Rated speed	2400		
额定扭力(Kg.cm) Rated torque	0.005		
额定功率(W) Rated power	0.2		
堵转电流(A) Stall current	0.3		
堵转扭力(Kg.cm) Stall torque	0.022		

减速电机性能 Gear motor performance	BVM26D300		
减速箱结构 Gear type	/		
减速比(i) Ratio	516		
空载转速(RPM) No load speed	/		
输出扭矩(N.m) Output torque	≥0.8		
最大瞬时扭矩(N.m) Max. torque	/		
重量(Kg) Weight	0.5		

备注 note:

- 1.减速电机电压, 转速, 扭矩可在一定范围内定制; Voltage,speed and torque of gear motors can be customized within a certain range.
- 2.部分减速电机可以加装编码器或刹车制动器; Encoder and brake are optional for some gear motors.
- 3.减速电机可以正反转, 调速; Gear motors can rotate CW or CCW,and speed adjustable.
- 4.扭矩 (扭力) 单位换算: 1N.m=10.2kg.cm=8.85lb.Inch=142.86oz.Inch.

接线示意图 Wiring diagram

A:
no driver-
inside:

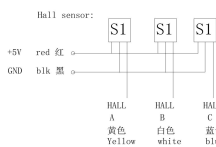

B:
driver-
inside:

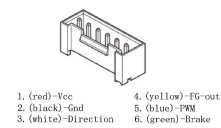

电机外形尺寸 (Unit : mm)

Outline & Dimension

外形尺寸图 (单位: mm)

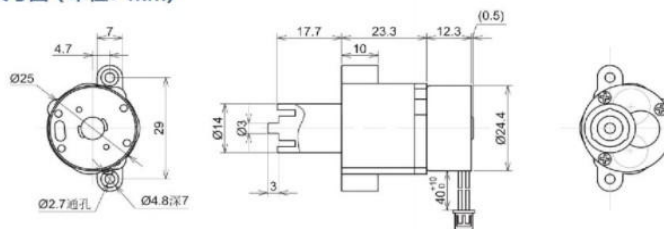

*尺寸图仅供参考, 减速箱的输出轴长, 轴径, 形状可以在一定范围内定制;

The drawing is for reference only,the shaft of gearbox can be customized within a certain range, such as the length,diameter and special shape.



BPM28EC2847

直流无刷减速电机

Planetary gear brushless dc motor



特点Features:

*无刷结构, 无摩擦, 低噪声, 寿命更长brushless structure,no contact, no friction ,lower noise,longer life time than brushed.
*无刷,无接触电阻, 效率更高brushless,no contact resistance,no voltage loss, has higher efficiency
*无积碳, 更可靠brushless,no carbon deposit,more reliable

应用Application:

搬运车, 轨道交通, 机器人, 数控设备, 农业, 办公设备, 工业设备, 军用设备
AGV,Rail Transport,Robot,Agricultural machine, CNC,Industrial machinery,military machinery

电机型号 Model of electric motor	EC2847		
电机类型 Motor structure	Brushless PM		
额定电压(V) Rated voltage	12	18	24
空载电流(A) No load current	0.24	0.19	0.18
空载转速(RPM) No load speed	6000	6500	6500
额定电流(A) Rated current	1.12	0.92	0.72
额定转速(RPM) Rated speed	4500	4800	4800
额定扭力(Kg.cm) Rated torque	0.17	0.18	0.18
额定功率(W) Rated power	3.2	3	3
堵转电流(A) Stall current	3.2	3	3
堵转扭力(Kg.cm) Stall torque	0.67	0.72	0.72

减速电机性能 Gear motor performance	BPM28EC2847										
减速箱结构 Gear type	Planetary										
减速比(i) Ratio	4	19	27	51	100	189	264	369	516	720	
空载转速(RPM) at 12v No load speed	1500	315	222	117	60	31	22	16	12	8	
输出扭矩(N.m) Output torque	0.028	0.12	0.12	0.25	0.48	0.9	1.2	1.56	2.2	2.2	
最大瞬时扭矩(N.m) Max. torque	2.2										
重量(Kg) Weight	0.5										

备注 note:

- 1.减速电机电压, 转速, 扭矩可在一定范围内定制; Voltage,speed and torque of gear motors can be customized within a certain range.
- 2.部分减速电机可以加装编码器或刹车制动器; Encoder and brake are optional for some gear motors.
- 3.减速电机可以正反转、调速; Gear motors can rotate CW or CCW,and speed adjustable.
- 4.扭矩 (扭力) 单位换算: 1N.m=10.2kg.cm=8.85lb.Inch=142.86oz.Inch.

接线示意图

Wiring diagram

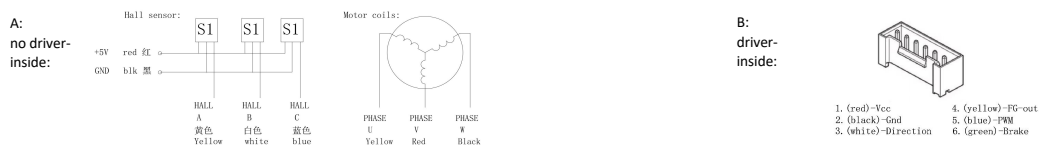

电机外形尺寸 (Unit : mm)

Outline & Dimension

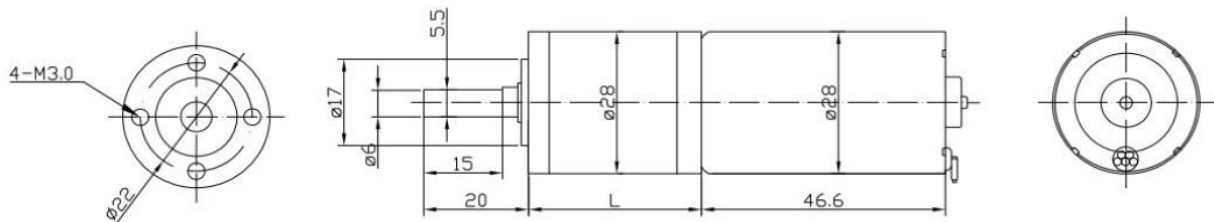

*尺寸图仅供参考, 减速箱的输出轴长, 轴径, 形状可以在一定范围内定制;

The drawing is for reference only,the shaft of gearbox can be customized within a certain range, such as the length,diameter and special shape.



BGM25EC2418

直流无刷减速电机

Spur gear brushless dc motor



特点Features:

*无刷结构, 无摩擦, 低噪声, 寿命更长brushless structure,no contact, no friction ,lower noise,longer life time than brushed.
*无刷,无接触电阻, 效率更高brushless,no contact resistance,no voltage loss, has higher efficiency
*无积碳, 更可靠brushless,no carbon deposit,more reliable

应用Application:

搬运车, 轨道交通, 机器人, 数控设备, 农业, 办公设备, 工业设备, 军用设备
AGV,Rail Transport,Robot,Agricultural machine, CNC,Industrial machinery,military machinery

电机型号 Model of electric motor	BGM25EC2418										
电机类型 Motor structure	Brushless PM										
额定电压(V) Rated voltage	12					24					
空载电流(mA) No load current	90					70					
空载转速(RPM) No load speed	6200					8700					
额定电流(mA) Rated current	180					150					
额定转速(RPM) Rated speed	4800					7000					
额定扭力(gf.cm) Rated torque	20					20					
额定功率(W) Rated power	1.4					2.5					
堵转电流(mA) Stall current	750					700					
堵转扭力(gf.cm) Stall torque	105					130					

减速电机性能 Gear motor performance	BGM25EC2418											
减速箱结构 Gear type	spur											
减速比(i) Ratio	4	10	21	34	47	78	103	130	227	499		
空载转速(RPM) No load speed	1560	650	300	185	136	84	66	49	27	12		
输出扭矩(kgf.cm) Output torque	0.06	0.145	0.32	0.45	0.64	0.99	1.15	1.46	2.58	5.7		
最大瞬时扭矩(kgf.cm) Max. torque	11											
重量(Kg) Weight	1											

备注 note:

- 1.减速电机电压, 转速, 扭矩可在一定范围内定制; Voltage,speed and torque of gear motors can be customized within a certain range.
- 2.部分减速电机可以加装编码器或刹车制动器; Encoder and brake are optional for some gear motors.
- 3.减速电机可以正反转、调速; Gear motors can rotate CW or CCW,and speed adjustable.
- 4.扭矩 (扭力) 单位换算: 1N.m=10.2kg.cm=8.85lb.Inch=142.86oz.Inch.

电机外形尺寸 (Unit : mm)

Outline & Dimension

外形尺寸/Appearance dimension(mm)

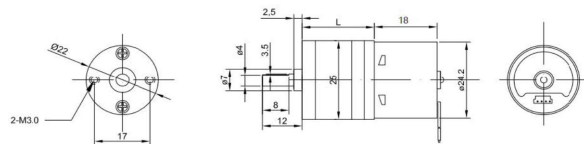

*尺寸图仅供参考, 减速箱的输出轴长, 轴径, 形状可以在一定范围内定制;

The drawing is for reference only,the shaft of gearbox can be customized within a certain range, such as the length,diameter and special shape.



BP80EC8086

直流无刷减速电机

Planetary gear brushless dc motor

特点Features:

*无刷结构, 无摩擦, 低噪声, 寿命更长brushless structure,no contact, no friction ,lower noise,longer life time than brushed.
*无刷,无接触电阻, 效率更高brushless,no contact resistance,no voltage loss, has higher efficiency
*无积碳, 更可靠brushless,no carbon deposit,more reliable

应用Application:

搬运车, 轨道交通, 机器人, 数控设备, 农业, 办公设备, 工业设备, 军用设备
AGV,Rail Transport,Robot,Agricultural machine, CNC,Industrial machinery,military machinery



电机型号 Model of electric motor	EC8086		
电机类型 Motor structure	Brushless PM		
额定电压(V) Rated voltage	48	310	
空载电流(A) No load current			
空载转速(RPM) No load speed	3600	3600	
额定电流(A) Rated current			
额定转速(RPM) Rated speed			
额定扭力(Kg.cm) Rated torque	0.4N.m 0.7N.m	1.2N.m	
额定功率(W) Rated power			
堵转电流(A) Stall current			
堵转扭力(Kg.cm) Stall torque			
减速电机性能 Gear motor performance	BP80EC8086		
减速箱结构 Gear type	Planetary		
减速比(i) Ratio			
空载转速(RPM) No load speed			
输出扭矩(N.m) Output torque			
最大瞬时扭矩(N.m) Max. torque			
重量(Kg) Weight	2-3kg		

备注 note:

- 1.减速电机电压, 转速, 扭矩可在一定范围内定制; Voltage,speed and torque of gear motors can be customized within a certain range.
- 2.部分减速电机可以加装编码器或刹车制动器; Encoder and brake are optional for some gear motors.
- 3.减速电机可以正反转、调速; Gear motors can rotate CW or CCW,and speed adjustable.
- 4.扭矩 (扭力) 单位换算: 1N.m=10.2kg.cm=8.85lb.Inch=142.86oz.Inch.

接线示意图

Wiring diagram

A:
no driver-
inside:

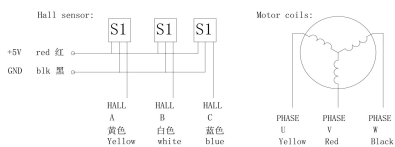

B:
driver-
inside:

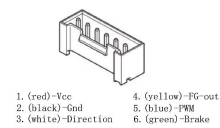

电机外形尺寸 (Unit : mm)

Outline & Dimension

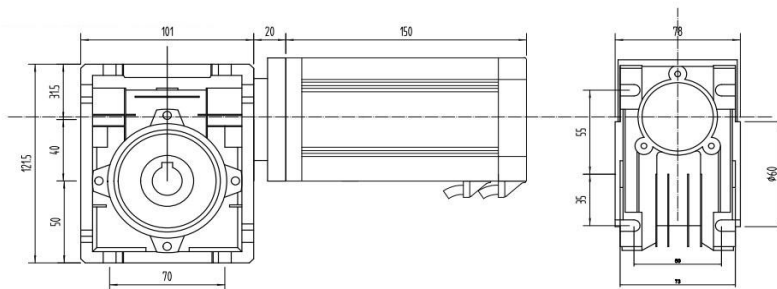

*尺寸图仅供参考, 减速箱的输出轴长, 轴径, 形状可以在一定范围内定制;

The drawing is for reference only,the shaft of gearbox can be customized within a certain range, such as the length,diameter and special shape.



BPM28D385

直流行星有刷减速电机

Planetary geared brushed dc motor



特点Features:

- *可靠耐用Durable
- *长寿命Long life time
- *效率高High efficiency

应用Application:

搬运车, 轨道交通, 机器人, 农业机械, 太阳能设备
AGV,Rail Transport,Robot,Agricultural machine,Solar machinery

电机型号 Model of electric motor	D385		
电机类型 Motor structure	Brush PM		
额定电压(V) Rated voltage	12	14.4	24
空载电流(A) No load current	0.98	0.9	0.85
空载转速(RPM) No load speed	4000	3600	4800
额定电流(A) Rated current	10	7	8
额定转速(RPM) Rated speed	2800	3000	5000
额定扭力(Kg.cm) Rated torque	11.8	19	11.8
额定功率(W) Rated power	300	440	380
堵转电流(A) Stall current	30	30	36
堵转扭力(Kg.cm) Stall torque	20	22	33

减速电机性能 Gear motor performance	BPM28D385												
减速箱结构 Gear type	worm												
减速比(i) Ratio	3	4	5	8	10	16	25	40	64	80	100	120	
空载转速(RPM) No load speed	3000	2200	1600	1200	900	500	380	220	150	120	150	120	
输出扭矩(N.m) Output torque	1	2	3	4	5	6	7	8	9	10	9	10	
最大瞬时扭矩(N.m) Max. torque	20												
重量(Kg) Weight	0.5												

备注 note:

- 1.减速电机电压, 转速, 扭矩可在一定范围内定制; Voltage,speed and torque of gear motors can be customized within a certain range.
- 2.部分减速电机可以加装编码器或刹车制动器; Encoder and brake are optional for some gear motors.
- 3.减速电机可以正反转、调速; Gear motors can rotate CW or CCW,and speed adjustable.
- 4.扭矩 (扭力) 单位换算: 1N.m=10.2kg.cm=8.85lb.Inch=142.86oz.Inch.

接线示意图

Wiring diagram

电机外形尺寸 (Unit : mm)

Outline & Dimension

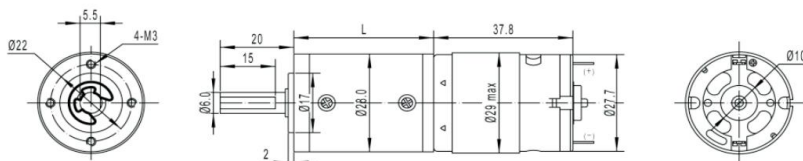

*尺寸图仅供参考, 减速箱的输出轴长, 轴径, 形状可以在一定范围内定制;

The drawing is for reference only,the shaft of gearbox can be customized within a certain range, such as the length,diameter and special shape.



BGM27D320

直流有刷减速电机

Spur geared brushed dc motor



特点Features:

- *双轴承Double bearings
- *经济型Economic
- *低噪声Low noise

应用Application:

电动阀门及执行器, 玩具, 机器人, 智能家居
Electric valve and actuator, Roy, Robot, Smart household

电机型号 Model of electric motor	D370		
电机类型 Motor structure	Brush PM		
额定电压(V) Rated voltage	12	14.4	24
空载电流(A) No load current	0.98	0.9	0.85
空载转速(RPM) No load speed	4000	3600	4800
额定电流(A) Rated current	10	7	8
额定转速(RPM) Rated speed	2800	3000	5000
额定扭力(Kg.cm) Rated torque	11.8	19	11.8
额定功率(W) Rated power	300	440	380
堵转电流(A) Stall current	30	30	36
堵转扭力(Kg.cm) Stall torque	20	22	33

减速电机性能 Gear motor performance	W22D370												
减速箱结构 Gear type	worm												
减速比(i) Ratio	3	4	5	8	10	16	25	40	64	80	100	120	
空载转速(RPM) No load speed	3000	2200	1600	1200	900	500	380	220	150	120	150	120	
输出扭矩(N.m) Output torque	1	2	3	4	5	6	7	8	9	10	9	10	
最大瞬时扭矩(N.m) Max. torque	20												
重量(Kg) Weight	0.5												

备注 note:

1. 减速电机电压, 转速, 扭矩可在一定范围内定制; Voltage, speed and torque of gear motors can be customized within a certain range.
2. 部分减速电机可以加装编码器或刹车制动器; Encoder and brake are optional for some gear motors.
3. 减速电机可以正反转, 调速; Gear motors can rotate CW or CCW, and speed adjustable.
4. 扭矩 (扭力) 单位换算: 1N.m=10.2kg.cm=8.85lb.Inch=142.86oz.Inch.

接线示意图

Wiring diagram

电机外形尺寸 (Unit : mm)

Outline & Dimension

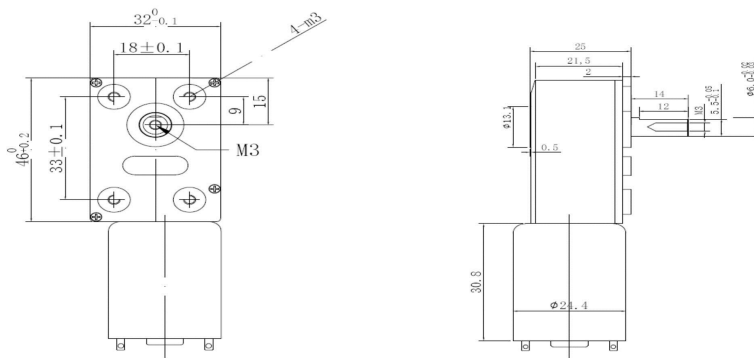

*尺寸图仅供参考, 减速箱的输出轴长, 轴径, 形状可以在一定范围内定制;

The drawing is for reference only, the shaft of gearbox can be customized within a certain range, such as the length, diameter and special shape.



W22D370

蜗轮蜗杆直流有刷减速电机

Worm geared brushed dc motor

特点Features:

- *自锁Self-lock
- *大负载Big load
- *可靠, 低噪声Reliable and low noise

应用Application:

搬运车, 轨道交通, 机器人, 农业机械
AGV,Rail Transport,Robot,Agricultural machine

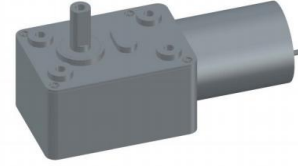

电机型号 Model of electric motor	D370											
电机类型 Motor structure	Brush PM											
额定电压(V) Rated voltage	12	14.4	24									
空载电流(A) No load current	0.98	0.9	0.85									
空载转速(RPM) No load speed	4000	3600	4800									
额定电流(A) Rated current	10	7	8									
额定转速(RPM) Rated speed	2800	3000	5000									
额定扭力(Kg.cm) Rated torque	11.8	19	11.8									
额定功率(W) Rated power	300	440	380									
堵转电流(A) Stall current	30	30	36									
堵转扭力(Kg.cm) Stall torque	20	22	33									
减速电机性能 Gear motor performance	W22D370											
减速箱结构 Gear type	worm											
减速比(i) Ratio	3	4	5	8	10	16	25	40	64	80	100	120
空载转速(RPM) No load speed	3000	2200	1600	1200	900	500	380	220	150	120	150	120
输出扭矩(N.m) Output torque	1	2	3	4	5	6	7	8	9	10	9	10
最大瞬时扭矩(N.m) Max. torque	20											
重量(Kg) Weight	0.5											

备注 note:

- 1.减速电机电压, 转速, 扭矩可在一定范围内定制; Voltage,speed and torque of gear motors can be customized within a certain range.
- 2.部分减速电机可以加装编码器或刹车制动器; Encoder and brake are optional for some gear motors.
- 3.减速电机可以正反转、调速; Gear motors can rotate CW or CCW,and speed adjustable.
- 4.扭矩 (扭力) 单位换算: 1N.m=10.2kg.cm=8.85lb.Inch=142.86oz.Inch.

接线示意图

Wiring diagram

电机外形尺寸 (Unit : mm)

Outline & Dimension

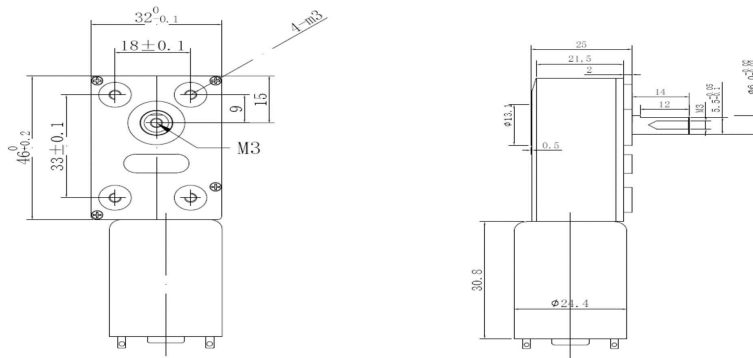

*尺寸图仅供参考, 减速箱的输出轴长, 轴径, 形状可以在一定范围内定制;

The drawing is for reference only,the shaft of gearbox can be customized within a certain range, such as the length,diameter and special shape.



W28-EC3650

直流无刷减速电机

Worm gear brushless dc motor

特点Features:

- *无刷电机寿命更长brushless motor, longer life time than brushed model.
- *无刷电机效率更高brushless motor has higher efficiency
- *可靠, 低噪声Reliable and low noise

应用Application:

搬运车, 轨道交通, 机器人, 农业机械, 太阳能设备, 道闸系统
AGV, Rail Transport, Robot, Agricultural machine, Solar machine, barrier gate system

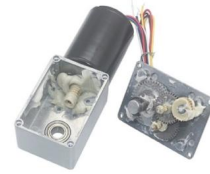

电机型号 Model of electric motor	W28-EC3650			
电机类型 Motor structure	Brushless with hall			
额定电压(V) Rated voltage	12	24		
空载电流(mA) No load current	220	300		
空载转速(RPM) No load speed	6000	9000		
额定电流(mA) Rated current	500	800		
额定转速(RPM) Rated speed	5700	8500		
额定扭力(gf.cm) Rated torque	240	210		
额定功率(W) Rated power	14	18		
堵转电流(mA) Stall current	3400	4200		
堵转扭力(gf.cm) Stall torque	2250	1180		

减速电机性能 Gear motor performance	W28-EC3650						
减速箱结构 Gear type	worm						
减速比(i) Ratio	26	81	135	207	405	621	
空载转速(RPM) No load speed	230	74	44	29	15	10	
输出扭矩(kgf.cm) Output torque	6.1	18	19	19	19	19	
最大瞬时扭矩(kgf.cm) Max. torque	30						
重量(Kg) Weight	0.5						

备注 note:

1. 减速电机电压, 转速, 扭矩可在一定范围内定制; Voltage, speed and torque of gear motors can be customized within a certain range.
2. 部分减速电机可以加装编码器或刹车制动器; Encoder and brake are optional for some gear motors.
3. 减速电机可以正反转, 调速; Gear motors can rotate CW or CCW, and speed adjustable.
4. 扭矩 (扭力) 单位换算: 1N.m=10.2kg.cm=8.85lb.Inch=142.86oz.Inch.

接线示意图

Wiring diagram

电机外形尺寸 (Unit: mm)

Outline & Dimension

外形尺寸/Appearance dimension(mm)

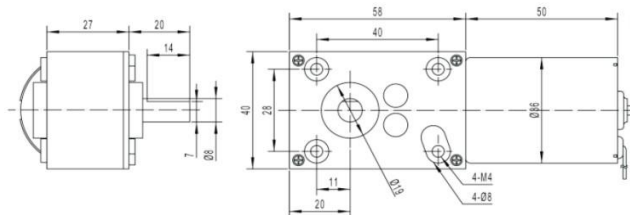

*尺寸图仅供参考, 减速箱的输出轴长, 轴径, 形状可以在一定范围内定制;

The drawing is for reference only, the shaft of gearbox can be customized within a certain range, such as the length, diameter and special shape.



BSP-94

直流无刷减速电机

Brushless dc spindle motor

特点Features:

- *无刷电机寿命更长brushless motor, longer life time than brushed model.
- *无刷电机效率更高brushless motor has higher efficiency
- *可靠, 低噪声Reliable and low noise

应用Application:

搬运车, 轨道交通, 机器人, 农业机械, 太阳能设备, 道闸系统
AGV, Rail Transport, Robot, Agricultural machine, Solar machine, barrier gate system



电机型号 Model of electric motor	BSP-94		
电机类型 Motor structure	Brushless with driver		
额定电压(V) Rated voltage	48		
空载电流(mA) No load current	/		
空载转速(RPM) No load speed	/		
额定电流(mA) Rated current	12A		
额定转速(RPM) Rated speed	12000rpm		
额定扭力(N.m) Rated torque	0.32		
额定功率(W) Rated power	400		
电机相数 Phase	3		
堵转扭力(gf.cm) Stall torque	/		
重量(Kg) Weight	1.5		

备注 note:

1. 减速电机电压, 转速, 扭矩可在一定范围内定制; Voltage, speed and torque of gear motors can be customized within a certain range.
2. 部分减速电机可以加装编码器或刹车制动器; Encoder and brake are optional for some gear motors.
3. 减速电机可以正反转、调速; Gear motors can rotate CW or CCW, and speed adjustable.
4. 扭矩 (扭力) 单位换算: 1N.m=10.2kg.cm=8.85lb.Inch=142.86oz.Inch.

接线示意图

Wiring diagram

电机外形尺寸 (Unit: mm)

Outline & Dimension

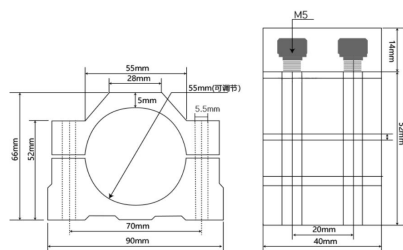

以上尺寸为手工测量, 有±1mm的误差, 敬请谅解!

*尺寸图仅供参考, 减速箱的输出轴长, 轴径, 形状可以在一定范围内定制;

The drawing is for reference only, the shaft of gear box can be customized within a certain range, such as the length, diameter and special shape.



BPM42-EC4260

直流无刷减速电机

Brushless dc motor



特点Features:

- *无刷电机寿命更长brushless motor ,longer life time than brushed model.
- *无刷电机效率更高brushless motor has higher efficiency
- *可靠, 低噪声Reliable and low noise

应用Application:

搬运车, 轨道交通, 机器人, 农业机械, 太阳能设备, 道闸系统
AGV,Rail Transport,Robot,Agricultural machine,Solar machine, barrier gate system

电机型号 Model of electric motor	BPM42-EC4260		
电机类型 Motor structure	Brushless without hall		
额定电压(V) Rated voltage	12 or 24		
空载电流(mA) No load current	/		
空载转速(RPM) No load speed	/		
额定电流(mA) Rated current	15A		
额定转速(RPM) Rated speed	12000rpm		
额定扭力(KG.CM) Rated torque	1.5		
额定功率(W) Rated power	157		
电机相数 Phase	3		
堵转扭力(gf.cm) Stall torque	/		
重量(Kg) Weight	1.5		

备注 note:

- 1.减速电机电压, 转速, 扭矩可在一定范围内定制; Voltage,speed and torque of gear motors can be customized within a certain range.
- 2.部分减速电机可以加装编码器或刹车制动器; Encoder and brake are optional for some gear motors.
- 3.减速电机可以正反转、调速; Gear motors can rotate CW or CCW,and speed adjustable.
- 4.扭矩 (扭力) 单位换算: 1N.m=10.2kg.cm=8.85lb.Inch=142.86oz.Inch.

接线示意图

Wiring diagram

电机外形尺寸 (Unit : mm)

Outline & Dimension

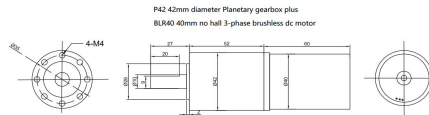

*尺寸图仅供参考, 减速箱的输出轴长, 轴径, 形状可以在一定范围内定制;

The drawing is for reference only,the shaft of gearbox can be customized within a certain range, such as the length,diameter and special shape.



BPM22EC2418 直流无刷减速电机 Brushless dc motor

特点Features:

- *无刷电机寿命更长brushless motor ,longer life time than brushed model.
- *无刷电机效率更高brushless motor has higher efficiency
- *可靠，低噪声Reliable and low noise

应用Application:

搬运车，轨道交通，机器人，农业机械,太阳能设备，道闸系统
AGV,Rail Transport,Robot,Agricultural machine,Solar machine, barrier gate system



电机型号 Model of electric motor	BPM22EC2418		
电机类型 Motor structure	Brushless DC motor		
额定电压(V) Rated voltage	12	24	
空载电流(mA) No load current	90	68	
空载转速(RPM) No load speed	6200	8600	
额定电流(mA) Rated current	180	50	
额定转速(RPM) Rated speed	4800	7000	
额定扭力(gf.cm) Rated torque	20	20	
额定功率(W) Rated power	1.4	2.5	
电机相数 Phase	/	/	
堵转扭力(gf.cm) Stall torque	105	130	
重量(Kg) Weight	1.5		

备注 note:

- 1.减速电机电压，转速，扭矩可在一定范围内定制； Voltage,speed and torque of gear motors can be customized within a certain range.
- 2.部分减速电机可以加装编码器或刹车制动器； Encoder and brake are optional for some gear motors.
- 3.减速电机可以正反转、调速； Gear motors can rotate CW or CCW,and speed adjustable.
- 4.扭矩（扭力）单位换算： 1N.m=10.2kg.cm=8.85lb.Inch=142.86oz.Inch.

接线示意图

Wiring diagram

电机外形尺寸 (Unit: mm)

Outline & Dimension

BPM22EC2418-2460

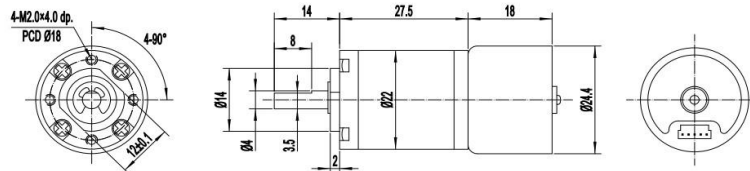

*尺寸图仅供参考，减速箱的输出轴长，轴径，形状可以在一定范围内定制；

The drawing is for reference only,the shaft of gear box can be customized within a certain range, such as the length,diameter and special shape.



RV30BLF60120

直流无刷减速电机

Worm gear brushless dc motor

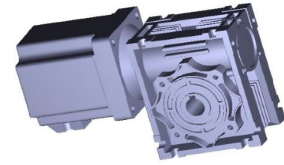

特点Features:

- *无刷电机寿命更长brushless motor ,longer life time than brushed model.
- *无刷电机效率更高brushless motor has higher efficiency
- *可靠，低噪声Reliable and low noise

应用Application:

搬运车，轨道交通，机器人，农业机械,太阳能设备，道闸系统
AGV,Rail Transport,Robot,Agricultural machine,Solar machine, barrier gate system

电机型号 Model of electric motor	BLF60120		
电机类型 Motor structure	Brushless with hall		
额定电压(V) Rated voltage	24	36	48
空载电流(A) No load current	2	1	0.6
空载转速(RPM) No load speed	3000	3000	3000
额定电流(A) Rated current	15	10	8
额定转速(RPM) Rated speed	2500	2500	2500
额定扭力(Kg.cm) Rated torque	11.8	19	11.8
额定功率(W) Rated power	300	300	300
堵转电流(A) Stall current	30	25	20
堵转扭力(Kg.cm) Stall torque	20	22	33

减速电机性能 Gear motor performance	RV30BLF60120												
减速箱结构 Gear type	worm												
减速比(i) Ratio	5	7.5	10	15	20	25	30	40	50	60	80	100	
空载转速(RPM) No load speed	3000	2200	1600	1200	900	500	380	220	150	120	150	120	
输出扭矩(N.m) Output torque	1	2	3	4	5	6	7	8	9	10	9	10	
最大瞬时扭矩(N.m) Max. torque	20												
重量(Kg) Weight	0.5												

备注 note:

- 1.减速电机电压，转速，扭矩可在一定范围内定制； Voltage,speed and torque of gear motors can be customized within a certain range.
- 2.部分减速电机可以加装编码器或刹车制动器； Encoder and brake are optional for some gear motors.
- 3.减速电机可以正反转，调速； Gear motors can rotate CW or CCW,and speed adjustable.
- 4.扭矩（扭力）单位换算：1N.m=10.2kg.cm=8.85lb.Inch=142.86oz.Inch.

接线示意图

Wiring diagram

电机外形尺寸 (Unit : mm)

Outline & Dimension

*尺寸图仅供参考，减速箱的输出轴长，轴径，形状可以在一定范围内定制；

The drawing is for reference only,the shaft of gearbox can be customized within a certain range, such as the length,diameter and special shape.